

1		2		3		4		5		6		7		8	
REVISIONS															
ISS	ZONE	DESCRIPTION\PER REQUEST\DATE													

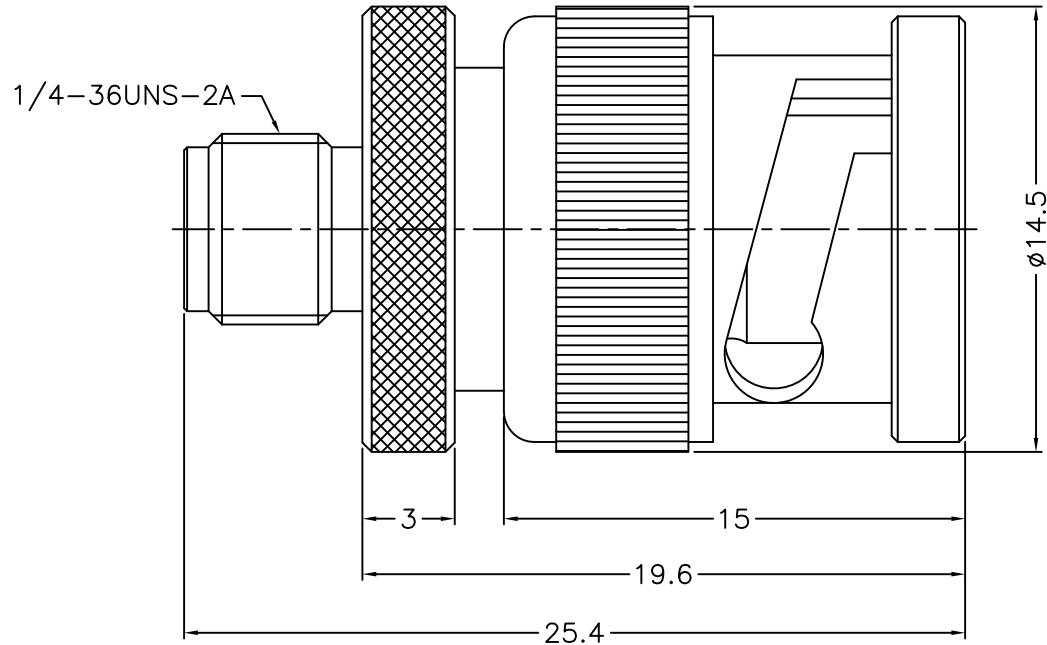

NOTES: FINISH (PLATING THICKNESS IN MICRO-INCHES)

- 1. BRASS
- 2. NICKEL PL. 100 MIN. THICK OVER COPPER PL. 50 MIN. THICK
- 3. PHOSPHOR BRONZE
- 4. GOLD PL. 3 MIN. THICK OVER NICKEL PL. 50 MIN. THICK OVER COPPER PL. 50 MIN. THICK
- 5. TEFLON

8	SHELL	NOTE 1	NOTE 2	1	900-1000-1	DIMENSIONS ARE IN MILLIMETERS		PART NO.		<b>G.L.I.</b>							
7	GASKET	RUBBER	RED	1	GS-80-115-15												
6	RETAINER RING	NOTE 1	NOTE 2	1	900-1000-5	UNLESS OTHERWISE SPECIFIED TOLERANCES 0.5-6 = ±0.2 6-30 = ±0.4 30-120 = ±0.6 120-315 = ±1 315-1000 = ±1.6 1000-2000 = ±2.4		APPROVED		DATE		TITLE SMA JACK TO BNC PLUG ADAPTOR					
5	SPRING	SK5	NOTE 2	1	900-1000-6					07-25-'12							
4	WASHER	NOTE 1	NOTE 2	1	WS-90-128-08					CHECKED		DATE		DRAWING NO. 100-SMAF1-BM-50			
3	CONTACT PIN	NOTE 3	NOTE 4	1	100-SMAF-BM-3							07-25-'12					
2	INSULATOR	NOTE 5	NATURAL	1	100-SMAF-BM-2-50T					DRAWN		DATE		FILE NO. R:\D\G\DWG\100\SMAF1-BM\50			
1	BODY	NOTE 1	NOTE 2	1	100-SMAF-BM-1					07-25-'12							
NO.	DESCRIPTION	MATERIAL	FINISH	Q'TY	DRAWING NO.	SCALE	4/1	ISSUE	A								